



BIOLOX® OPTION

Femoral Head System



BIOLOX® OPTION –

The BIOLOX®OPTION System is intended for use either for cup revision or ball head exchange for in situ prosthesis stems. The femoral heads and sleeves are designed specifically for use with United Orthopedic femoral stems.

Benefit of the BIOLOX® OPTION System

- High surgical flexibility with various head sizes and neck lengths
- Adaptation to a new stem taper or mildly damaged stem taper
- A low-wear bearing option in revision cases
- Diamond-like hardness to resist third-body wear
- The range of motion is unaffected with the sleeve



*BIOLOX® is a registered trademark of the CeramTec Group, Germany

More OPTION for revision surgery

-The femoral heads are made from BIOLOX® *delta* ceramics and are available in 28, 32, 36 and 40 mm options depending on the selected cup size

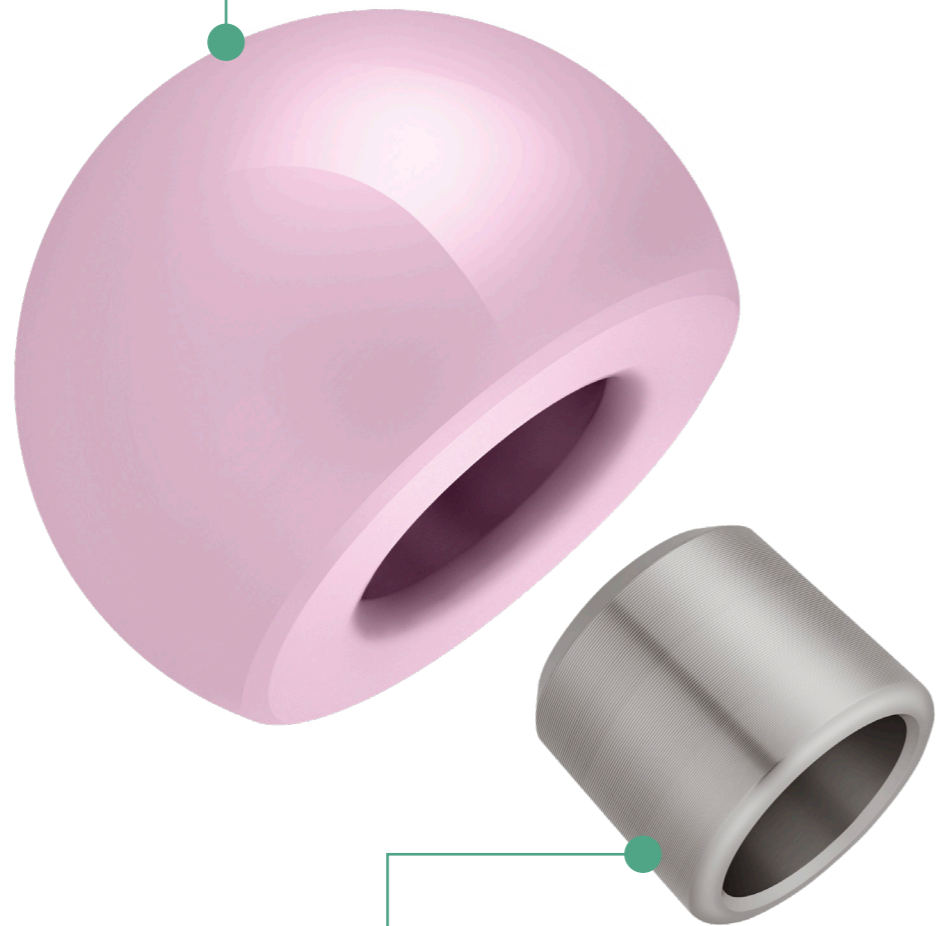

-Titanium sleeves are available in 4 neck length, S (-2 mm), M (+1 mm), L (+5 mm) and XL (+8 mm)

Tolerable condition in using the BIOLOX® OPTION Head



Undamaged stem taper

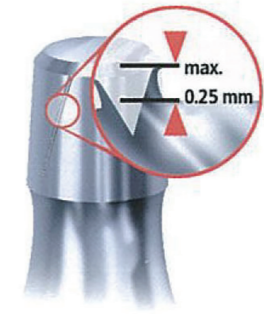

Mild scratches
(less than 0.25 mm in width)

Intolerable condition in using the BIOLOX® OPTION Head



Heavily scratched taper



Taper with broad truncation



Crushed taper



Assembling the BIOLOX® OPTION Head System

- BIOLOX OPTION® femoral head and the sleeve are packaged together.
- Place the femoral head onto the sleeve while applying manual pressure. Care should be taken to axially align the head and the sleeve.
- After the modular head system is set, engage it onto the stem taper by using only the plastic head impactor.

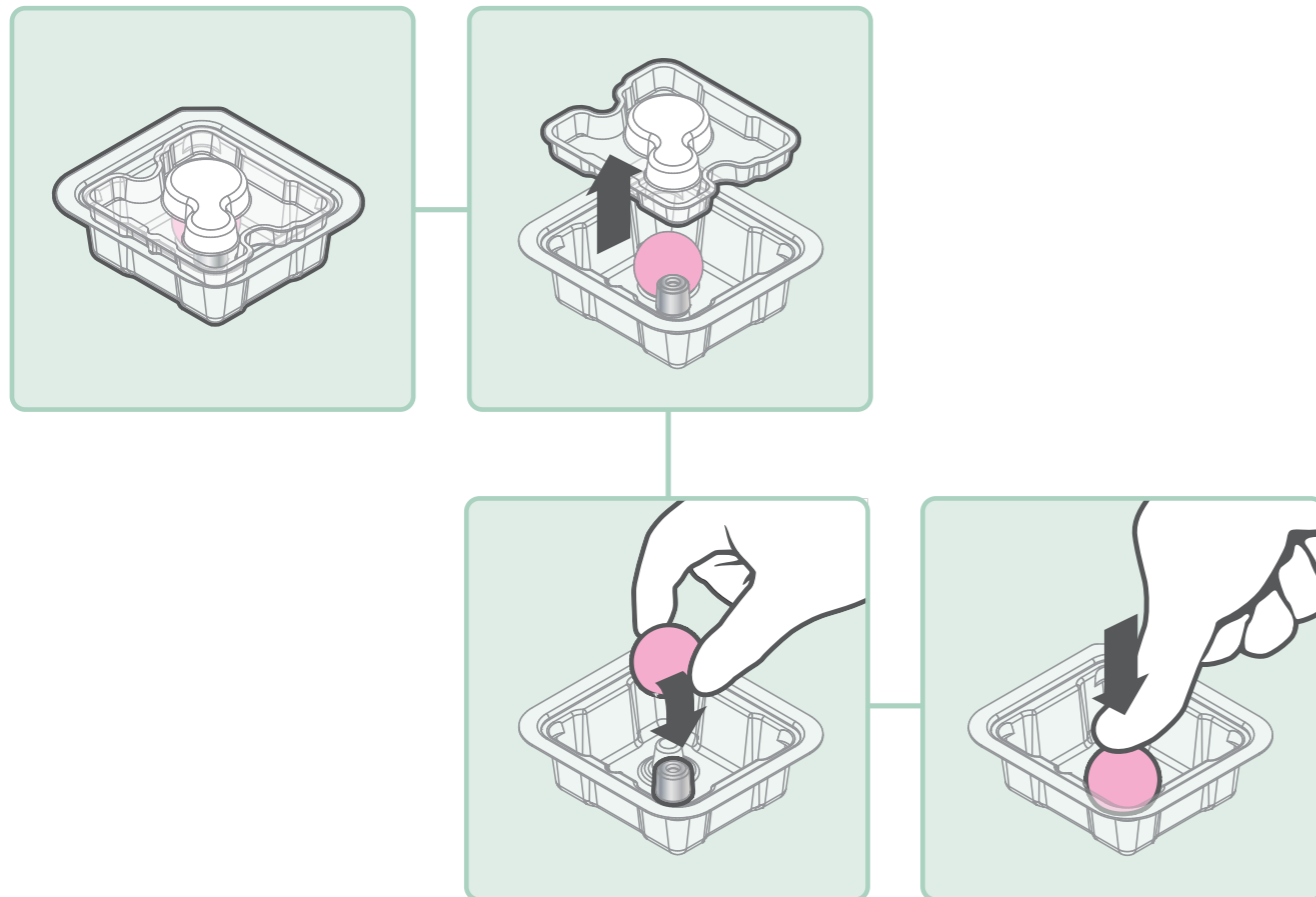

Order Information



| Catalog Number | Description | | |
|----------------|-------------|----|-----|
| 1203 - 7028 | Ø 28 mm | S | - 2 |
| 1203 - 7228 | Ø 28 mm | M | + 1 |
| 1203 - 7428 | Ø 28 mm | L | + 5 |
| 1203 - 7628 | Ø 28 mm | XL | + 8 |
| 1203 - 7032 | Ø 32 mm | S | - 2 |
| 1203 - 7232 | Ø 32 mm | M | + 1 |
| 1203 - 7432 | Ø 32 mm | L | + 5 |
| 1203 - 7632 | Ø 32 mm | XL | + 8 |
| 1203 - 7036 | Ø 36 mm | S | - 2 |
| 1203 - 7236 | Ø 36 mm | M | + 1 |
| 1203 - 7436 | Ø 36 mm | L | + 5 |
| 1203 - 7636 | Ø 36 mm | XL | + 8 |
| 1203 - 7040 | Ø 40 mm | S | - 2 |
| 1203 - 7240 | Ø 40 mm | M | + 1 |
| 1203 - 7440 | Ø 40 mm | L | + 5 |
| 1203 - 7640 | Ø 40 mm | XL | + 8 |

Importiert & vertrieben in der Schweiz durch
Importé & distribué en Suisse par
Importato e distribuito in Svizzera da



Aeschwahrstrasse 54 info.ch@plusortho.ch
CH-4665 Oftringen tel +41(0)62 788 2010
www.plusortho.ch fax +41(0)62 788 2011

Please note that all United Orthopedic Corporation product brochures have been authored in the English language. Any translations into other languages have not been reviewed or approved by United Orthopedic Corporation and their accuracy cannot be confirmed. Any questions regarding United Orthopedic Corporation products should be directed to United Orthopedic Corporation at unitedorthopedic.com/contact.

The CE mark is valid only if it is also printed on the product label.

